

In order to prevent the variety of problems which caused by incorrect operation,
Please read the manual first before operating this machine and pay attention to the items
marked in “note”.

Please keep this manual carefully for checking when needed.

Summary

- ✧ Transportation, installation, safe operation of moving and operating methods and attentions;
- ✧ Installation and operation;
- ✧ Function adjustment;
- ✧ Maintenance;
- ✧ General troubleshooting and solutions;
- ✧ Main components diagram;

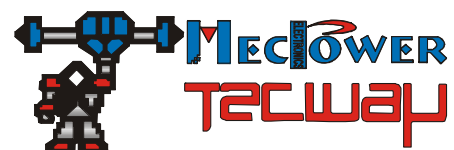

Safety Attentions

- 1) Certain part of the game is with high voltage. Adjust the game by technician. Do not open the game door unless maintenance or parts replacement is required.
- 2) Please switch off the power before checking and maintenance.
- 3) Please switch off the power before opening the game door.
- 4) Fire extinguisher equipment must be nearby the game.

Installation

The game must be located properly to avoid damages.

Improper Locations:

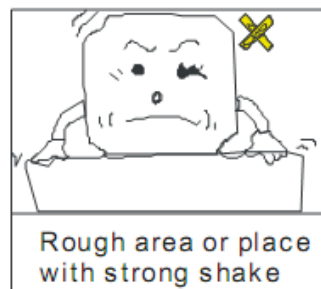
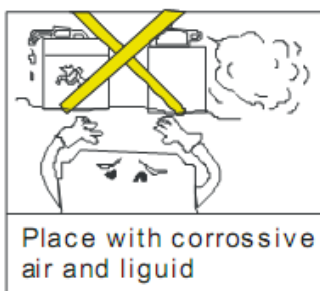
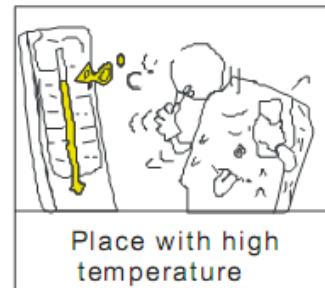
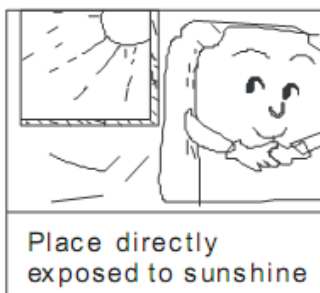

voltage should be 110V/220V. The specific voltage accords to the date plate on the back door of the game. The voltage must be correct; otherwise it would be difficult to repair the damage.

- 2) The plug must be plugged in tightly and keep the power cords not be too tight and damaged in order to prevent bodily injury, short-circuit and power leakage.
- 3) To put the machine to normal operating, please properly adjust the coin match

and the game settings when use at the first time.

- 4) Please regularly check all the functions of the game when operate to prevent dysfunction.

Notes of Maintenance

- 1) Be sure to check and maintain the game regularly.
- 2) Switch off the power before replacing the parts of the game.
- 3) The parts for replacement should be the same model as the old one.
- 4) Please check the connection and voltage output after replacing the power supply.
- 5) The voltage range of the PCB should be 5.1V-5.4V.
- 6) Check whether the game has creepage and the voltage before repairing the PCB.

Notes of Clean

- 1) Please use clean and soft cloth to clean the game.
- 2) Prevent damaging the surface of the game, please do not use the following cleanser:
 - Alterative Cleanser;
 - Acidic Cleanser;
 - Insecticide, sterilized water, alcohol or other chemical cleanser.

Notes of Moving and Shipping

- 1) Properly disassemble the game for necessary moving and shipping.
- 2) Prevent the game from hitting or being attrite during movement.
- 3) Protecting the case when move the game.

GAME INTRODUCTION

Power storm with unique, beautiful and comic appearance, interesting and exciting game, it is specially designed and developed by our company for the young people. It will be very essential and popular in amusement center.

Power storm is an animation and motion experience as one of the machine, when guests watch the amazing animation, can experience the visual stimulation, strong power, wind power, high and low sounds right surround sound and so on to make it perfect, immersive feeling.

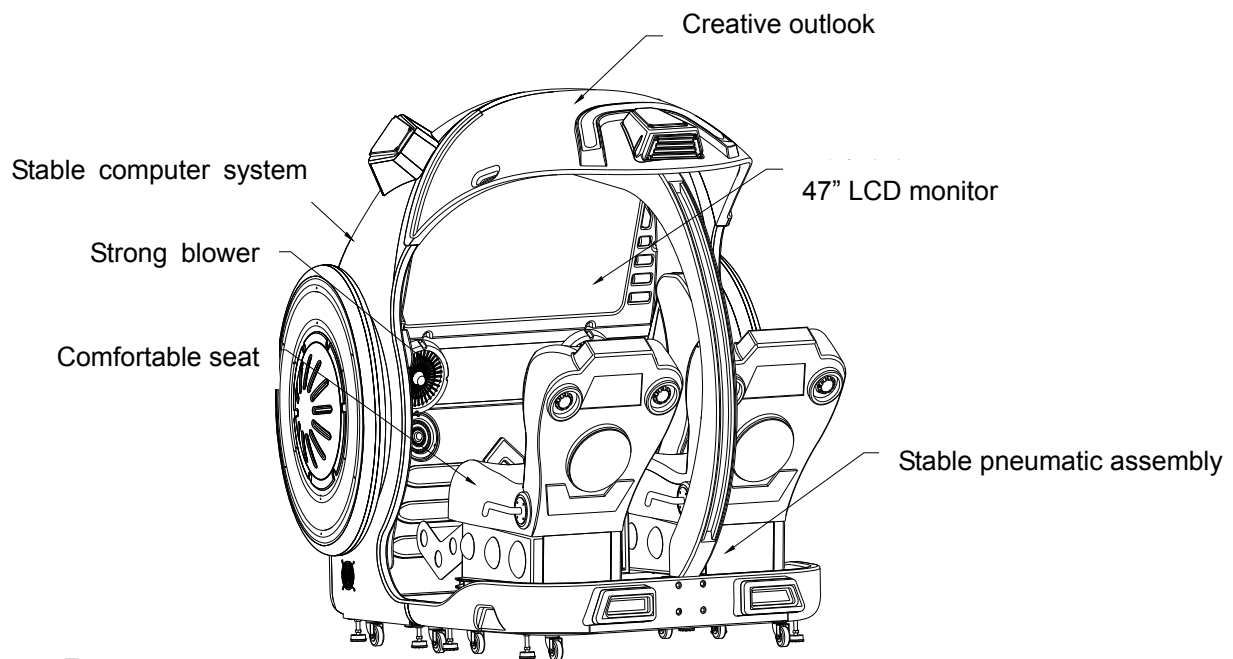

Features:

Realistic, colorful, cute outlook

Integrated main board, high-speed processing CPU, stable performance.

High definition, high-quality LCD display.

Surround sound effects

Simulate lifelike motion seats, stable and reliable dynamic components

Strong blower

Operating income can be adjusted according to the situation

PLAYING TIPS

Ride on the power storm and insert coin, press the button to choose what you want to start, 1) There are 4 shorts: Snow Storm ,Space Travelling , Chengdu J-20 ,The Great Wall of China. 2) Wait for a few seconds after the broadcast, the picture will be on blizzard or special angles such as the plane jets, in the process of forward will continue to have amazing scenery, will bring you very exciting visual experience, combined with simulate lifelike seat dynamic with strong and the sound of blowing around the has very good sensory experience. 3) Should hold your armrest in the process of watching, it can alleviate strong vibration caused by tension. 4) If you need in the process of watching, press movement to stop button, the seat will stop vibration; press movement to stop button again, it will restart the seat to move feeling.

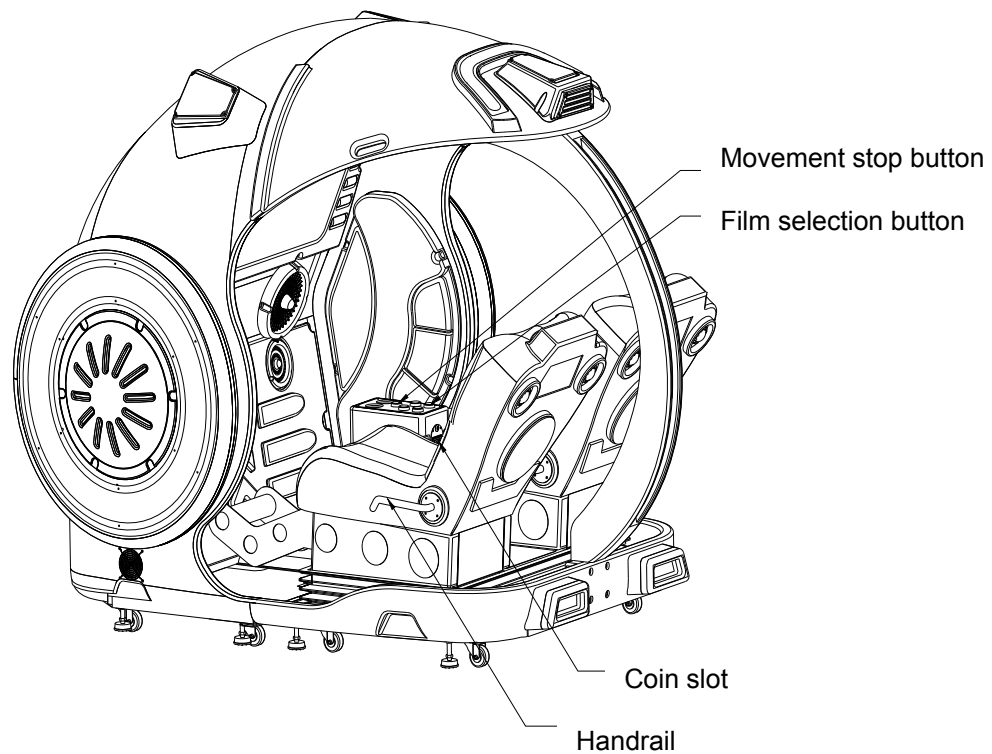

TECHNICAL PARAMETER

VOLTAGE: AC 220V/110V (50/60HZ)

MAX. CURRENT: 13A/26A

(Note: please refer to the nameplate located on the back of the games to check actual usage of voltage.)

MAX. POWER: 2860W

STANDBY POWER: 460W

COIN SIZE: $\phi 21\text{mm} \sim \phi 30\text{mm}$ (diameter)

1.2mm ~ 2.5mm (thickness)

CAPACITY OF COIN BOX: 1200pcs of coins with coin size $\phi 25\text{mm} \times 1.5\text{mm}$

LOCATION REQUIRED: $-5 \sim 40^{\circ}\text{C}$, humidity is less than 90%. No contact with any corrosive liquid, no any greasiness and dirt.

DIMENSIONS: L2650mm*W2030mm*H2200mm

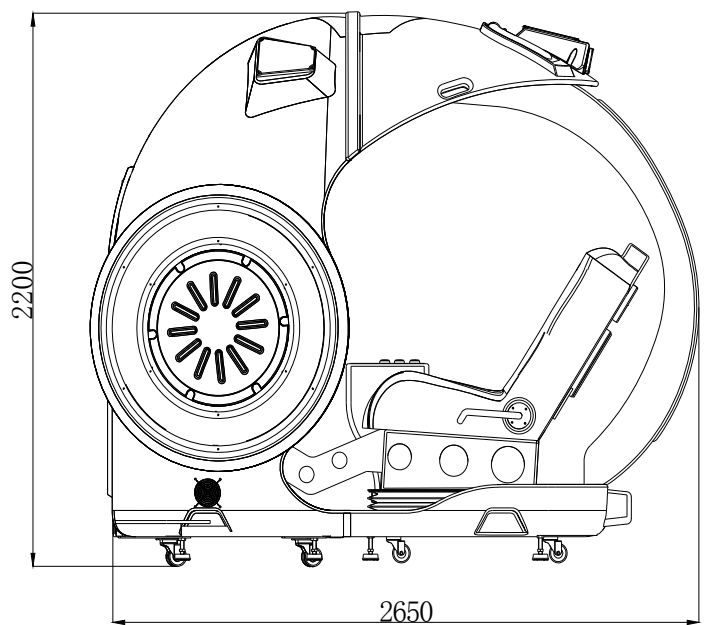
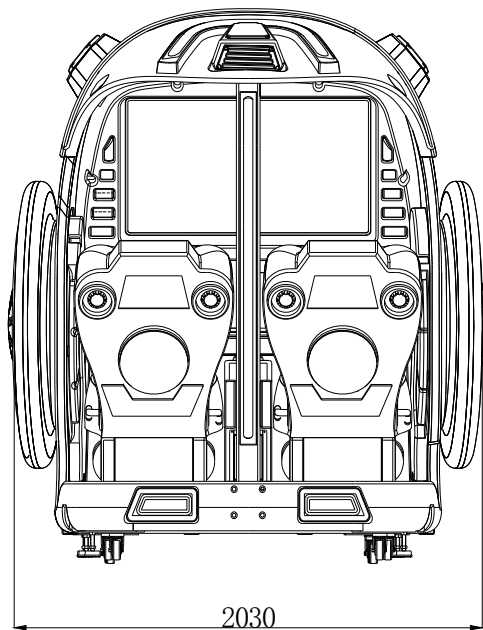

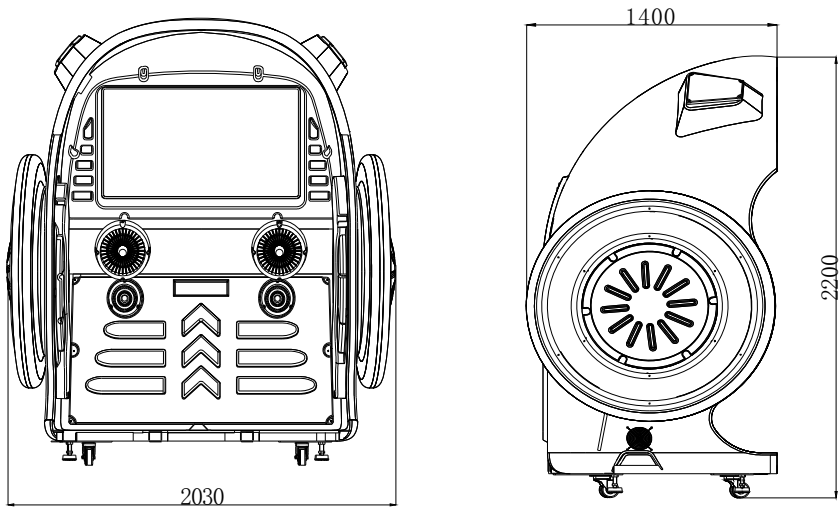

Chassis components size: L2030mm*W1400mm*H2200mm

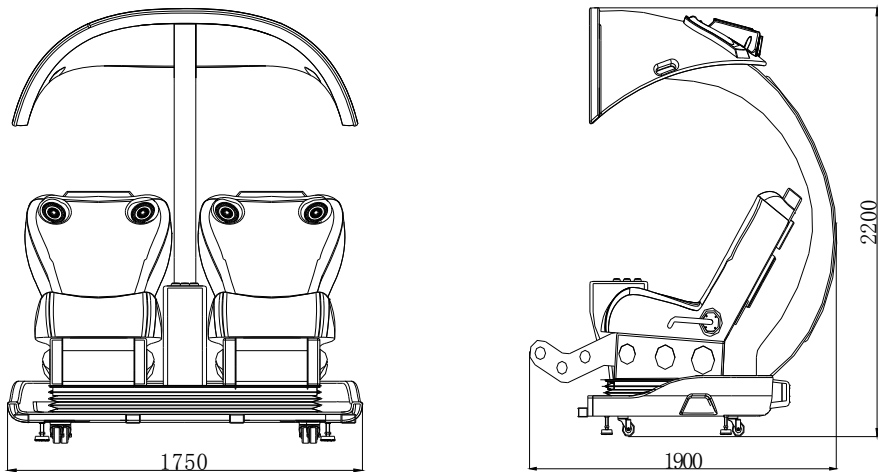

Chassis components size: L1900mm*W1750mm*H2200mm

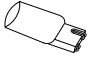
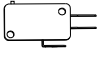
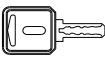
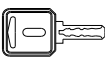

Parts shipped with the game:

| | | | | |
|---|---|--------------|--------|---|
| 1 |  | LED light | green | 2 |
| 2 |  | micro switch | | 2 |
| 3 |  | key | 1285 # | 2 |
| 4 |  | key | 1396 # | 2 |
| 5 |  | power cord | | 1 |
| 6 |  | manual | | 1 |

MOVEMENT

Direction of movement diagram:

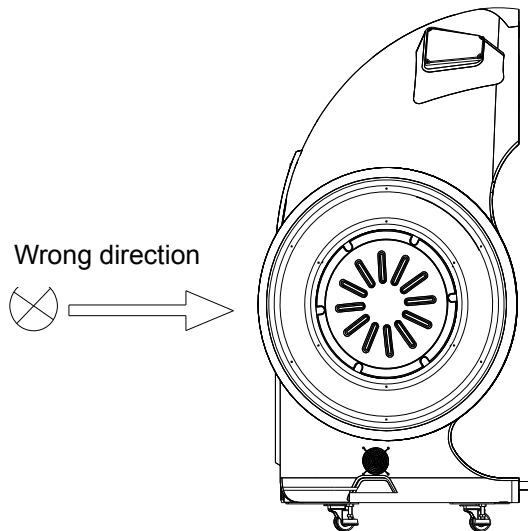

Seat components movement diagram:

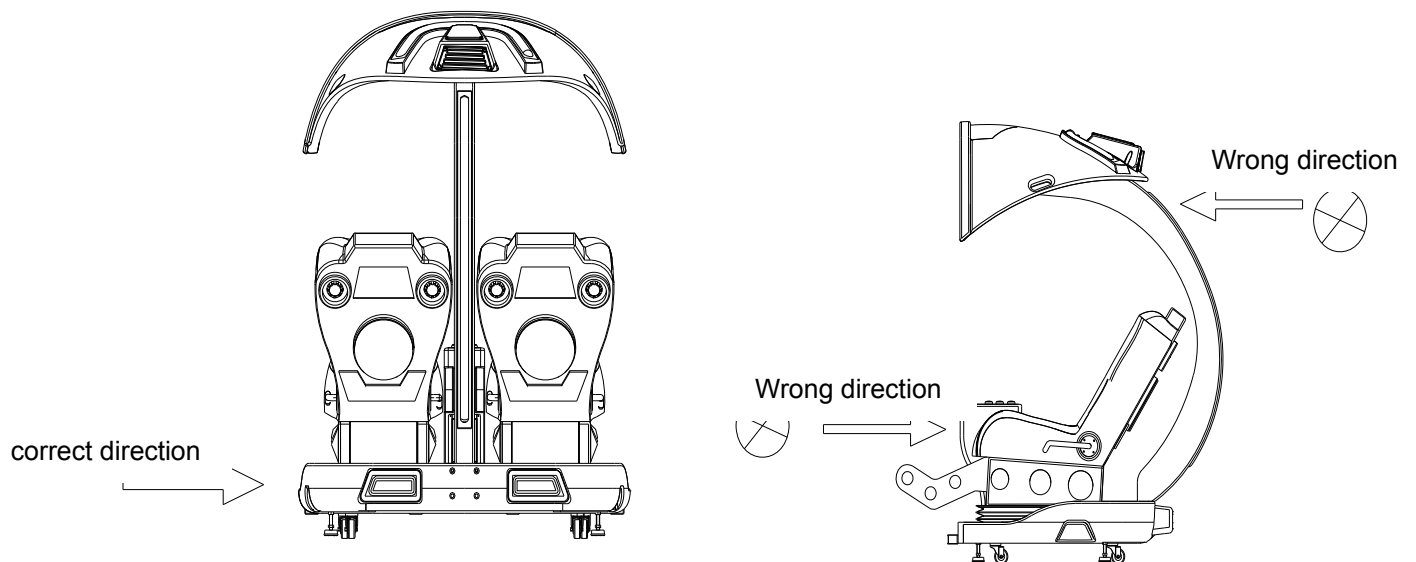

Note: when the road surface is uneven during moving or when you tilt the machine, please pay attention to the strength and hang the chassis in the air to prevent damage to the air sac.

WARNING

- Please power off the game first and pull out the cord, then move the game.
- Prevent hitting, rubbing the games when move the games, otherwise it will damage the appearance of the game.
- Please do not carefully move, turnover, transport the game; otherwise it will destroy the game.

INSTALLATION

Please follow the direction below to install the game.

Choose the location for installation:

- 1) Put the power storm in the same type of Kiddie Ride with monitor then select the concrete placement machine according to the machine's exterior.
- 2) Choose the proper location for installation, please follow the below drawing to install.

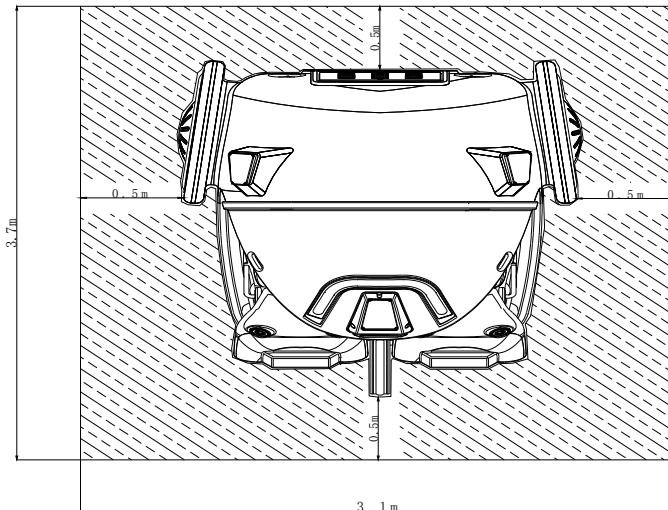

NOTE: It must be placed on the flat floor to make the machine on the ground steadily.

Installation:

- 1) After choosing the installation position, have a good connection on chassis components and the seat assembly.

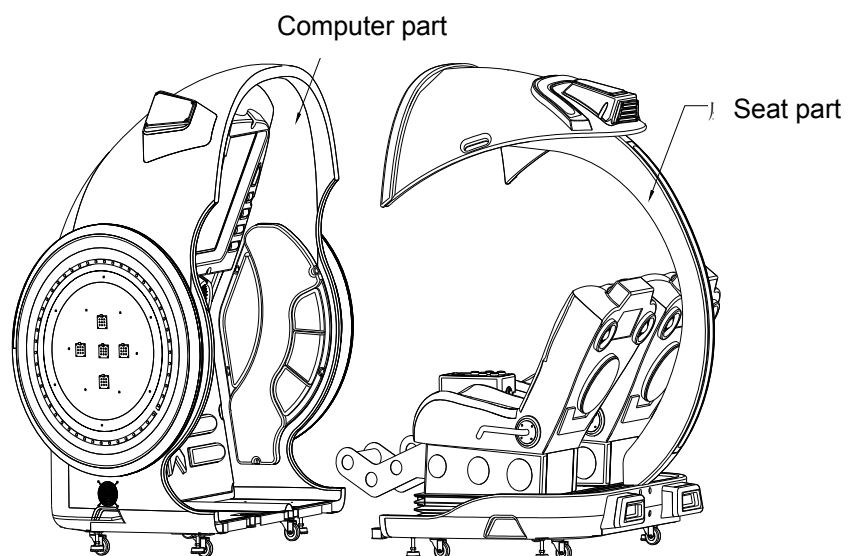

2) Put the seat part and chassis part together again and fix with six M8 * 35 screw, connect the connector and the seat air supply pipe joint.

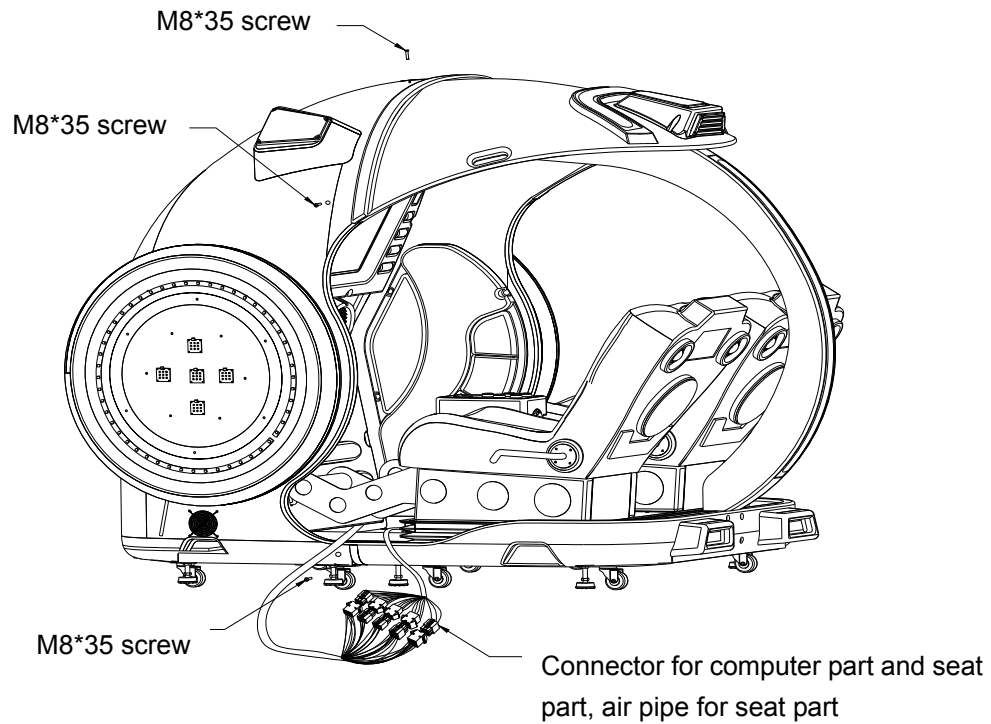

3) use the M4 * 20 big screw to fix the left and right sides of the yellow ring blister and white blister.

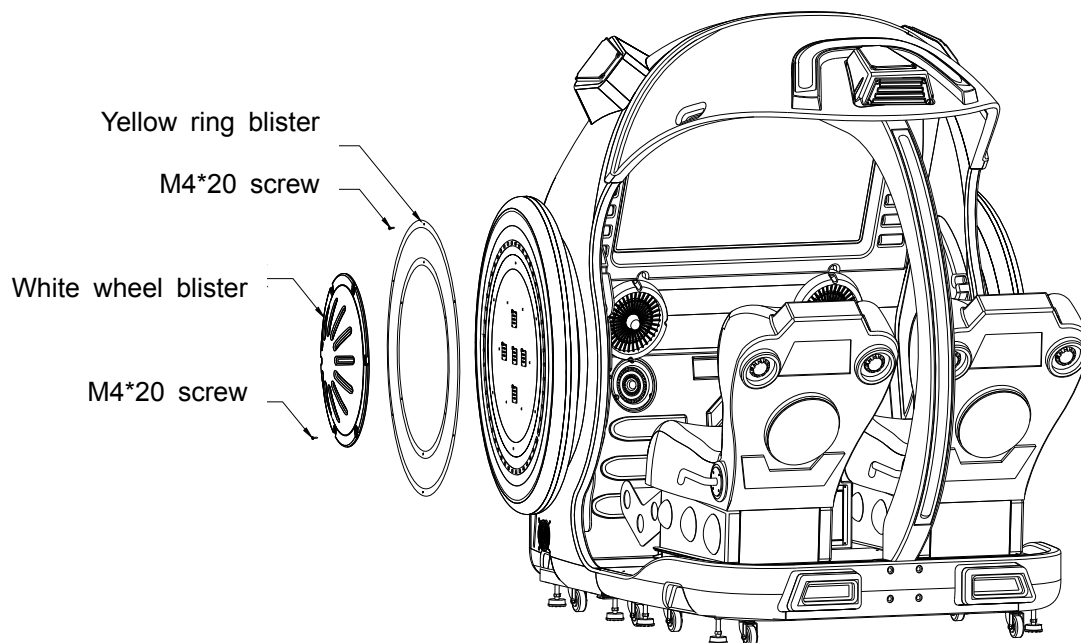

Fix the machine:

The machine must be laid flat on the ground, fixed machine need to adjust the anchor down, make the anchor bear the gravity of the whole machine, caster wheel off the ground about 10 mm (note: six fixed anchor is fixed to the ground, to prevent the seat vibration when the machine moving.

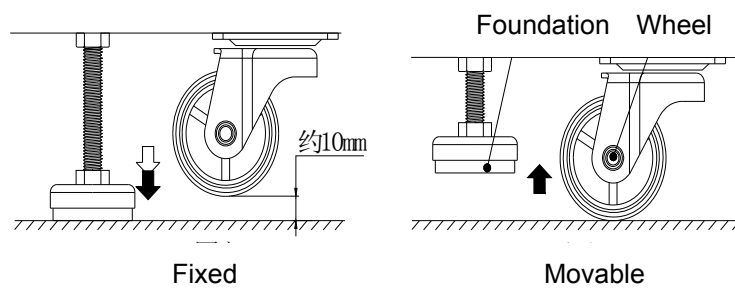
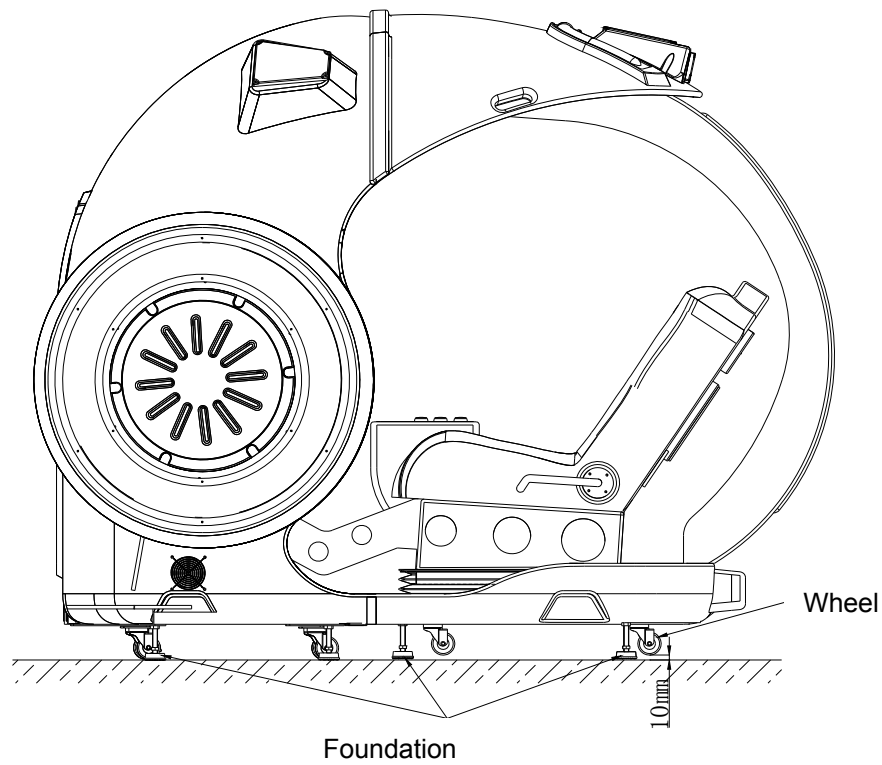

Check and set before connecting the power:

- 1) Please check the machine's internal structure for transportation vibration caused by loose, line connection terminals should not drop out.
- 2) Check the machine grounding line should be over the ground connection.
- 3) Check the machine's power input at both ends of the impedance of the ground should be greater than 100 megohm.
- 4) Connect the power cord. It is very important for connecting the power cord is related to personal safety, please see the following the correct connection methods, and can't use the wrong connection method, prevent the happening of the accident

The power for this machine is 13A, so can not use this kind of movable power box.

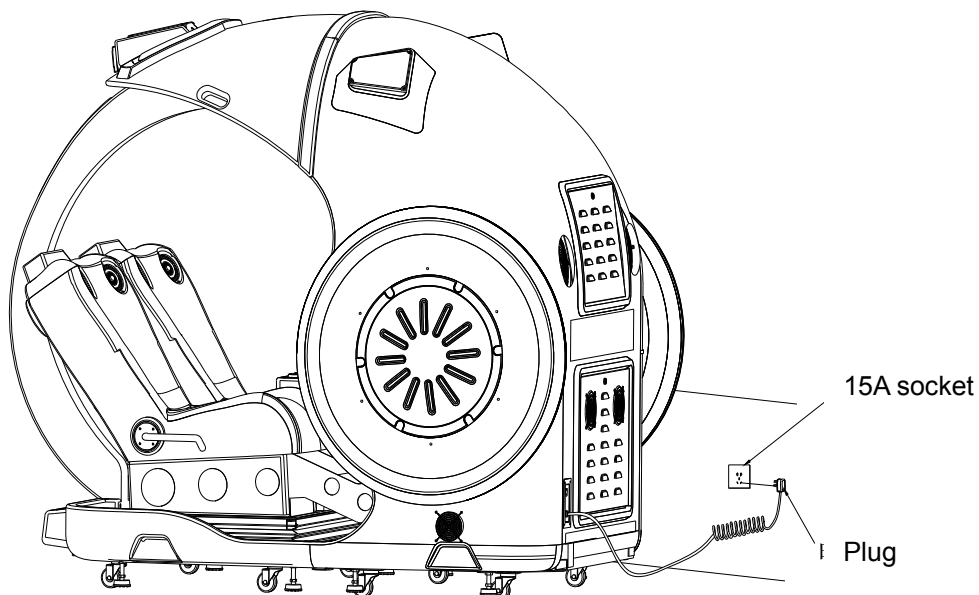
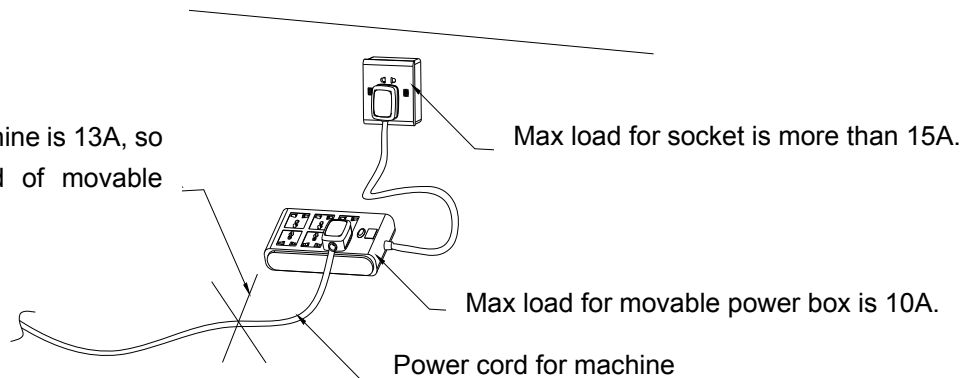

Attentions:

- A** Please make sure the power cord is not pressed by wheel, foundation, etc. Otherwise, it will damage the wire to cause short circuit, even fire. Do not use strong power to extend and wring the wires. Do not make the wire be near to the high temperature object. Properly put the wire to avoid any kicking or treading.

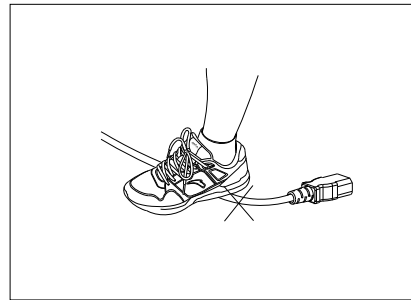
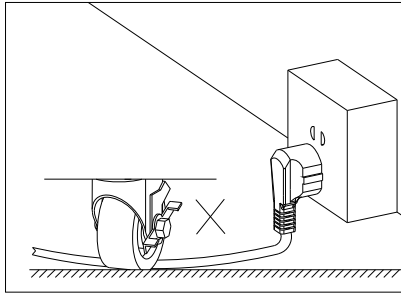

- B** Hold the plug to pull it out from the socket. Do not touch the plug with wet hands.

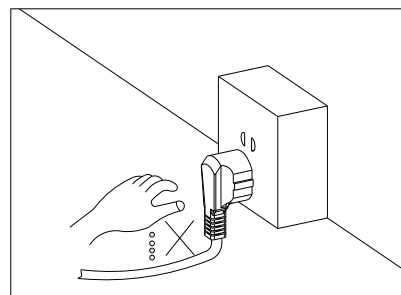
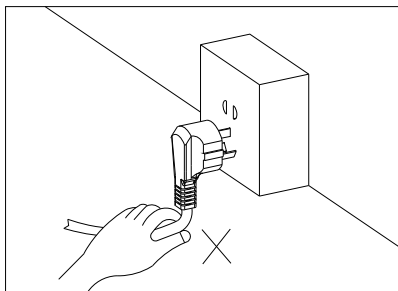

Check and Adjust after connecting the power:

- 1) Make sure the input voltage is same as the one stated on name plate on the back door of the game.
- 2) Confirm the biggest load current is greater than 15A of the machine power socket.
- 3) After connecting the power, please switch on the game.
- 4) Inserting coin to check if the coin machine can work properly.
- 5) Visually check the game and confirm the display and light can work properly.
- 6) Insert coin to play the game, confirm the fire button and the machine movement are normal.
- 7) Check the sound if it is ok.

Check before operation:

Check the game before operation to prevent the game from working improperly when operated.

Checking item:

- 1) Check if the cord is securely plugged in and without defects.
- 2) Check the location of game.
- 3) Check if the game case is without defects or burrs.
- 4) Check if the game without dirt and properly stuck on with marks.

DAILY OPERATION

Input the power

- 1) Turn on the machine power switch.
- 2) Visually check the game and confirm the display can work properly.
- 3) Check the sound if it is ok.
- 4) Confirm the coin mech, fire button and the machine movement is normal.

Warning: Before operation, please confirm all the items above are ok.

Check after operation:

- 1) Check the display of the game and confirm it is proper.
- 2) Double check the coin mech, fire button and the machine movement is normal; if it has any problems, please solve the problem as soon as possible.

Collect coins and keep record:

- 1) Switch off the power and open the door of the coin box to take out the coins
- 2) Open the door of the coin mech to keep a record of the coins' quantity.

GAME SETTINGS:

Keys for setting

Choose the content and result need to set, according to the set table toggle switch (ON or OFF), set up the game coin.

The SW ON the motherboard has eight small switches, switch the ON to switch conduction; To set the switch OFF to shut-off condition. Then set one of them can change the game coin.

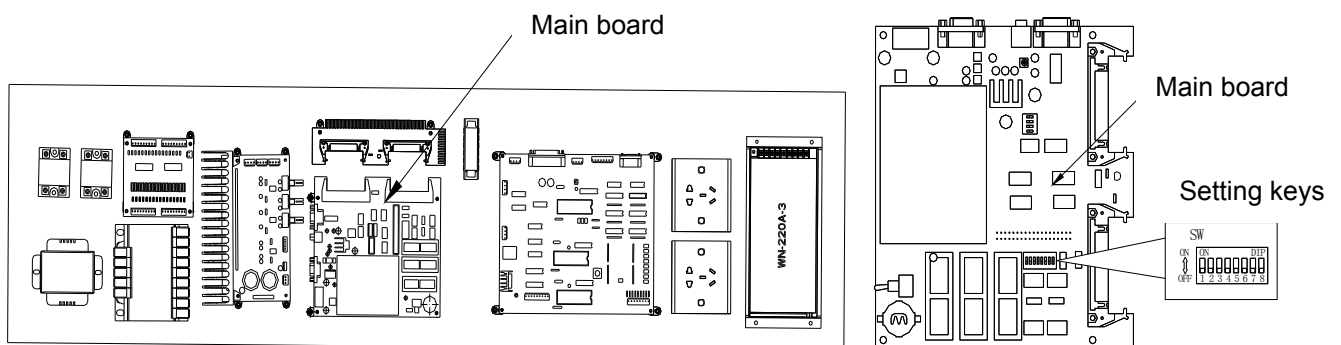

Setting chart:

| setting \ DIP SW1 | | 1 | 2 | 3 | 4 | 5 | 6 | 7 | 8 |
|----------------------|---------|-----|-----|-----|-----|-----|-----|-----|-----|
| no. of coin per play | 1 coin | OFF | OFF | OFF | OFF | OFF | OFF | OFF | OFF |
| | 2 coins | OFF | ON | OFF | OFF | OFF | OFF | OFF | OFF |
| | 3 coins | OFF | OFF | ON | OFF | OFF | OFF | OFF | OFF |
| | 4 coins | OFF | OFF | OFF | ON | OFF | OFF | OFF | OFF |
| | 5 coins | OFF | OFF | OFF | OFF | ON | OFF | OFF | OFF |
| | 6 coins | OFF | OFF | OFF | OFF | OFF | ON | OFF | OFF |
| | 7 coins | OFF | OFF | OFF | OFF | OFF | OFF | ON | OFF |
| | 8 coins | OFF | OFF | OFF | OFF | OFF | OFF | OFF | ON |

Descriptions:

1COIN[S]/1CREDIT[S]: this setting can decide how many coins for how many playing time, if set to "1COIN[S]/1 CREDIT[S]", it means insert 1 coins for 1 game.

adjust the coin mech



- 17

Adjust the volume:

Power amplifier plates can be adjusted to sign:

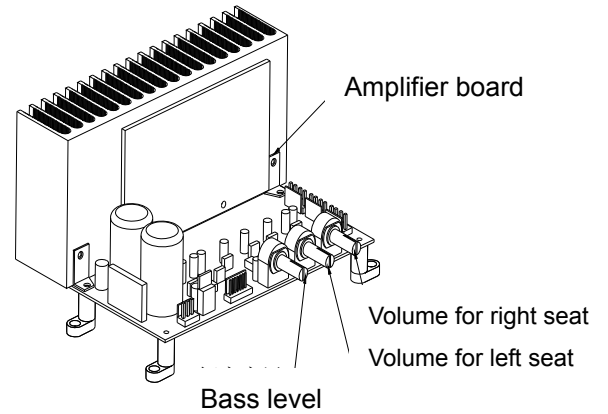
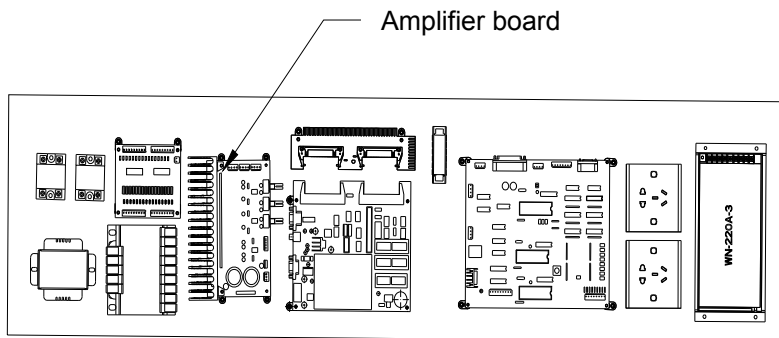

Descriptions:

Adjust the volume by twisting the volume potentiometer: twist clockwise to increase the volume, counterclockwise to decrease the volume.

As above drawing shown, you can select the potentiometer to adjust the volume of your choice.

Adjust the vibration range:

Vibration regulator

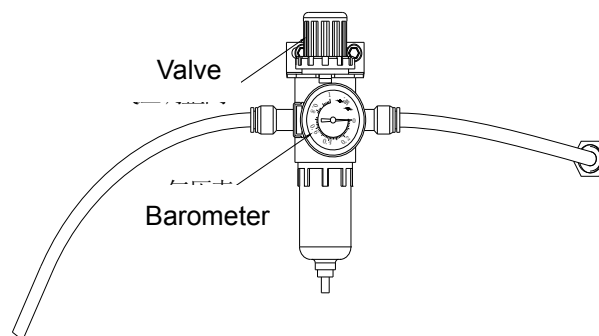

Vibration range adjustment

Pull up valve. Clockwisely turn the valve to increase air pressure, counterclockwisely to decrease air pressure.

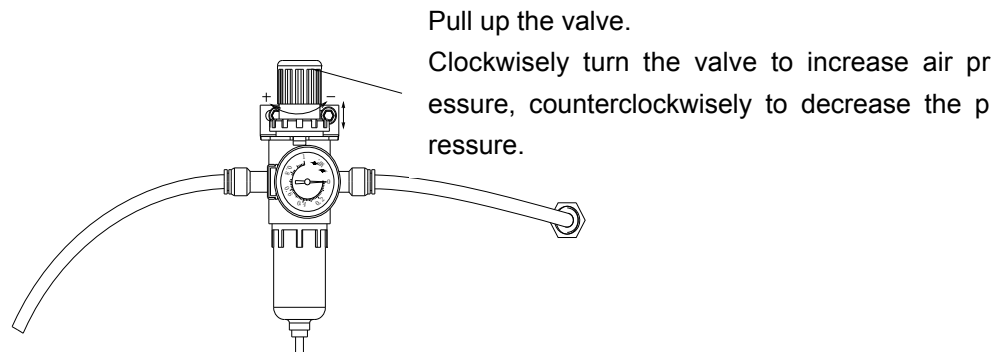

Warning:

The proper air pressure is from 0.2 to 0.5MP. The air pressure can not be less than 0.15MP and higher than 0.55MP. If the air pressure is too low or too high, it will affect the game and damage the air bag. Please do not adjust the air pressure of this game if not necessary.

CHECK AND MAINTAIN

! warning

- Please check and maintain the game by technicians.
- Please power off the game when check and maintain.
- Please do not put any tools into cabinet, otherwise it will cause problem.

After checking, please tightly screw the screws and close the door.

Daily Check

| ITEM | DESCRIPTION |
|--------------------------|---|
| Coin mech | Check whether the coin mech can work proper. |
| Fire button | Check whether the button can launch |
| Motion | Check whether the motion is proper |
| Sound | Check whether the sound and the volume are ok. |
| Display | Check if the displayed colors are proper. |
| Temperature、 humidity | Check if the temperature and humidity is proper |

Daily Maintenance

| ITEM | DESCRIPTION |
|----------|--|
| Cabinet | Clean the cabinet with water and soft paper. |
| Monitor | Clean the ABS for monitor with water and soft paper. |
| PCB | Sweep the dust and dirty in the board with small brush |
| Air Tank | Open the valve under the air tank to release the water. (once every three months) |

TROUBLESHOOTING

If you have any problem in installing or using the machine, we recommend that you first check the following table for possible cause of the problem and solution before asking for technical support:

| NO. | PROBLEMS | CAUSES | SOLUTIONS |
|-----|---|--|---|
| 1 | Can't insert coin | no sample coin | insert sample coin |
| | | sensitivity for coin was adjusted too high | adjust the sensitivity, screw the resistance (turn right) |
| | | Coin mech is bad. | Replace the coin mech. |
| 3 | The lights do not light up | Bad connection for the lights | Reconnect the wires of lights. |
| | | the lights failure | replace the lights |
| | | the light driving board is bad | Repair or replace the light driving board |
| 4 | The lights of light box do not light up | the lights board failure | maintain or replace the lights board |
| | | the circuit of power supply is blocked | check the connection of circuit |
| 5 | Air compressor does not work | Bad connection of air compressor. | Reconnect the wires of air compressor. |
| | | Start capacitor for air compressor is bad. | Replace the capacitor. |
| | | Protection switch for air compressor is bad. | Replace the switch. |
| | | Air compressor is bad. | Replace the air compressor. |
| 6 | Buttons invalid. | Bad connection for the button. | Reconnect the wires of button. |
| | | The button is bad. | Replace the button. |
| 7 | no display | Signal wire for monitor not connected yet. | check the connection of signal wire. |
| | | the monitor power line is loose | reconnect the monitor power line |
| | | the main board is bad. | replace the main board. |
| | | the monitor is bad | replace the monitor |
| 8 | no sound | The speaker is bad. | Check and replace the speaker. |
| | | Volume is too low. | Increase the volume. |
| | | The wire of speaker is loose. | Check the connection of speaker. |
| | | The amplifier board is bad | Repair or replace the amplifier board |
| 9 | No movement after powering on the game | no AC110V/220V input | Check the connection |
| | | no output voltage of power supply. | Repair or replace the power supply. |
| | | the computer motherboard does not work | maintain or replace the computer motherboard |

PARTS DRAWING AND PARTS LIST

Computer part:

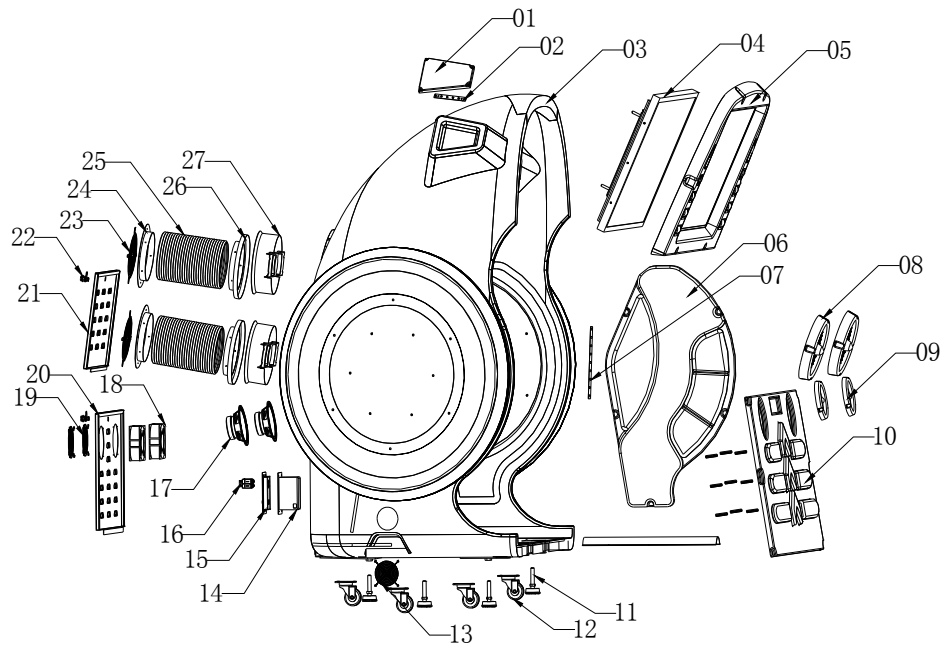

| NO. | NAME | QTY |
|-----|---------------------------------------|------|
| 01 | Top trapezoid blister | 1 |
| 02 | LED light strip blue | 0.2m |
| 03 | Fiberglass | 1 |
| 04 | 47" LCD monitor | 1 |
| 05 | Blister for monitor frame | 1 |
| 06 | Yellow & black blister for side light | 1 |
| 07 | LED light strip blue | 0.5m |
| 08 | 10" fan blister | 2 |
| 09 | 6" speaker blister | 2 |
| 10 | Front light blister | 1 |
| 11 | Foundation | 4 |
| 12 | Wheel | 4 |
| 13 | 8*8 fan mesh | 2 |
| 14 | Cover for power box | 1 |
| 15 | Power box | 1 |
| 16 | Protection switch | 1 |
| 17 | 6.5" speaker | 2 |

| NO. | NAME | QTY |
|-----|------------------------|-----|
| 18 | 15*15 fan | 2 |
| 19 | 15*15 fan mesh | 2 |
| 20 | Door for fan | 1 |
| 21 | Service door | 1 |
| 22 | Lock 1285# | 2 |
| 23 | Fan mesh | 2 |
| 24 | Holder 1 for vent pipe | 2 |
| 25 | Vent pipe | 2 |
| 26 | Holder 2 for vent pipe | 2 |
| 27 | 10" strong fan | 2 |

Side light:

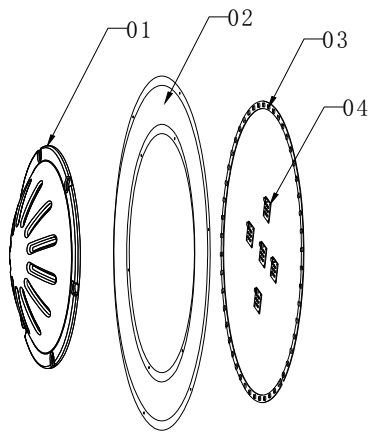

| NO. | NAME | QTY |
|-----|-----------------------------|-----|
| 01 | Big wheel blister | 2 |
| 02 | Yellow ring blister | 2 |
| 03 | LED light strip white | 5m |
| 04 | 3-color chasing light board | 10 |

Main board component:

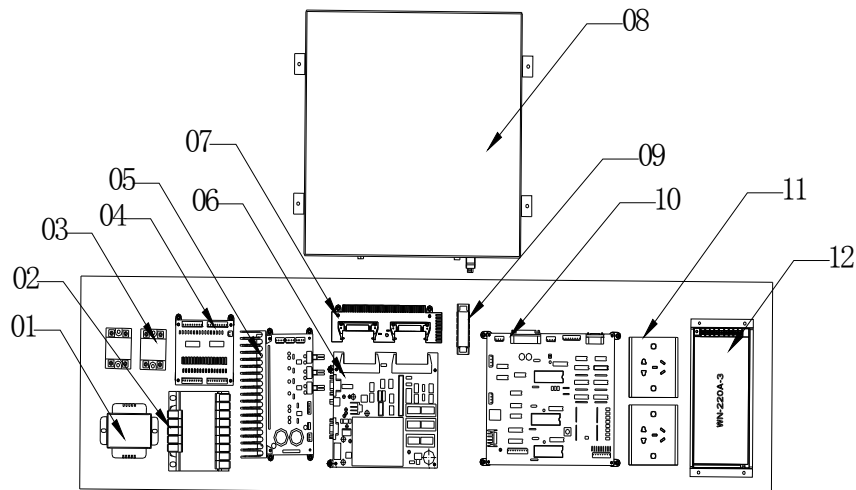

| NO. | NAME | QTY |
|-----|---------------------------|-----|
| 01 | Transformer 220V/18V 80W | 1 |
| 02 | Transformer 220V/18V 150W | 1 |
| 03 | Solid relay 25A | 2 |
| 04 | Signal amplifier | 1 |
| 05 | Amplifier | 1 |
| 06 | Main board | 1 |
| 07 | I/O board | 1 |
| 08 | Computer host | 1 |
| 09 | 6P connector | 1 |
| 10 | Signal converting board | 1 |
| 11 | Socket box | 1 |
| 12 | Power supply | 1 |

Pneumatic assembly:

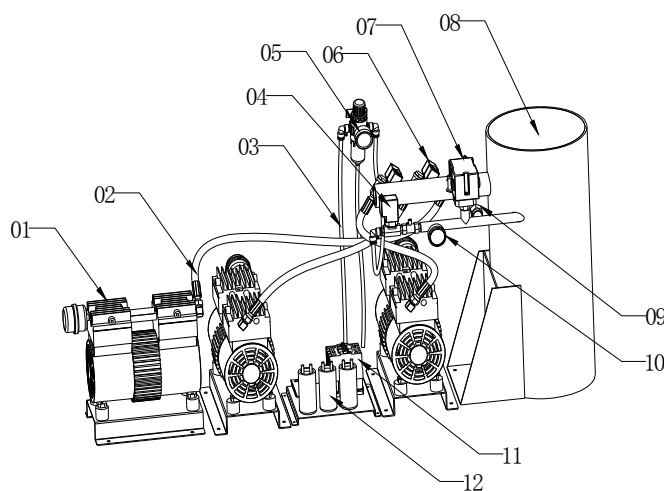

| NO. | NAME | QTY |
|-----|------------------------|-----|
| 01 | Air compressor 780W | 3 |
| 02 | High-pressure air pipe | 3 |
| 03 | Air pipe | 1M |
| 04 | Solenoid 2L 030-08 | 1 |
| 05 | Filter | 1 |
| 06 | Valve | 3 |
| 07 | Protection switch | 1 |
| 08 | Air tank | 1 |
| 09 | Protection valve | 1 |
| 10 | Barometer | 1 |
| 11 | AC contactor CJXZ-1810 | 1 |
| 12 | AC capacitor CBB60 | 3 |

Seat Part - top:

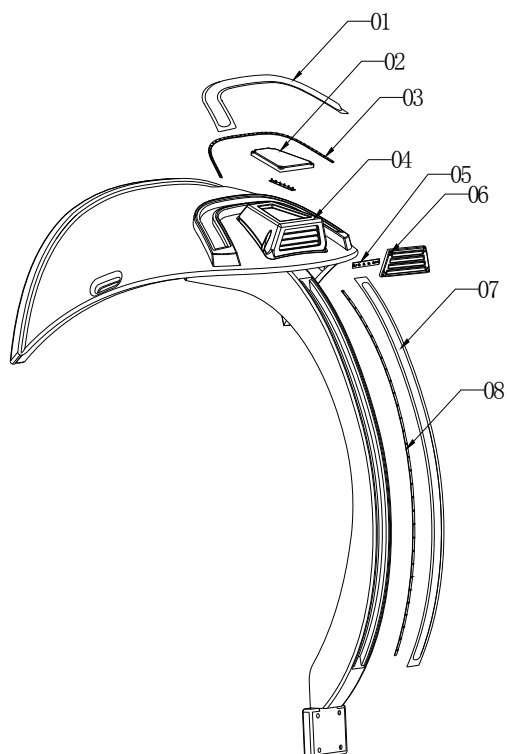

| NO. | NAME | QTY |
|-----|---------------------|------|
| 01 | U shape blister | 1 |
| 02 | White light lens | 1 |
| 03 | 7-color light strip | 1.2m |
| 04 | Fiberglass | 1 |
| 05 | LED light strip | 0.2m |
| 06 | Trapezoid blister | 1 |
| 07 | White acrylic board | 1 |
| 08 | LED light strip | 1.3m |

Seat assembly:

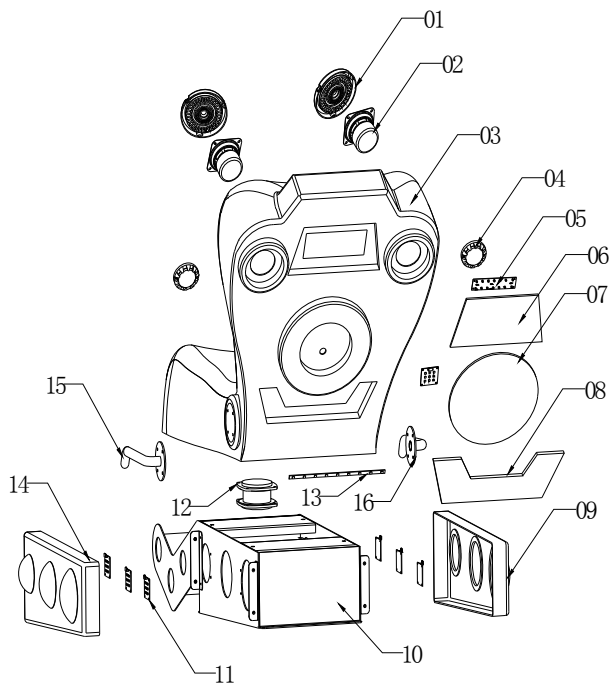

| NO. | NAME | QTY |
|-----|--------------------------------|------|
| 01 | Speaker blister | 4 |
| 02 | 4" speaker | 4 |
| 03 | Seat fiberglass | 2 |
| 04 | Big light | 4 |
| 05 | Chasing light white | 2 |
| 06 | Acrylic 1 | 2 |
| 07 | Acrylic 2 | 2 |
| 08 | Acrylic 3 | 2 |
| 09 | Right blister for seat chassis | 2 |
| 10 | Seat chassis | 2 |
| 11 | 3-color chasing light board | 6 |
| 12 | Vibrator | 2 |
| 13 | LED light strip blue | 0.4m |
| 14 | Left blister for seat chassis | 2 |
| 15 | Left handrail | 2 |
| 16 | Right handrail | 2 |

Seat part – underneath:

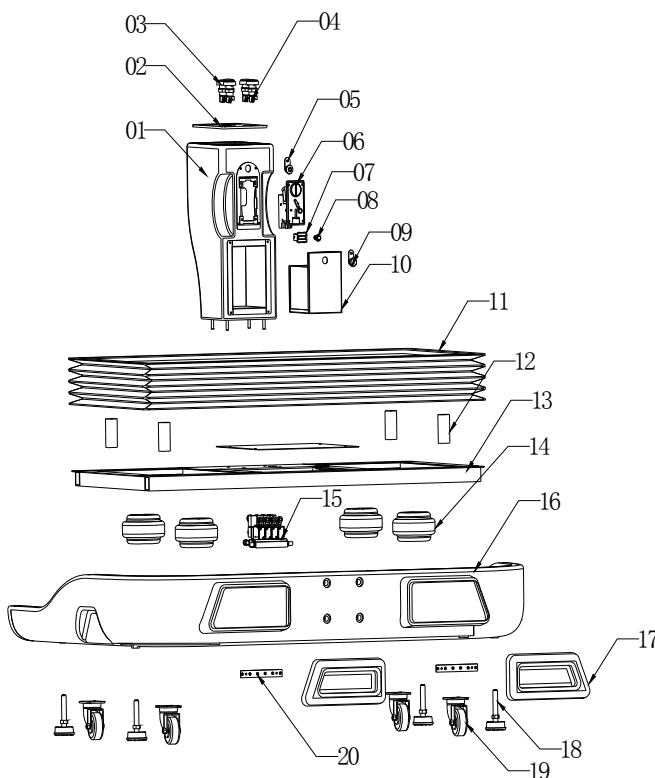

| NO. | NAME | QTY |
|-----|---------------------------------|------|
| 01 | Fiberglass for control panel | 1 |
| 02 | Acrylic board for control panel | 1 |
| 03 | Round button | 5 |
| 04 | Micro switch | 5 |
| 05 | Lock 1285# | 1 |
| 06 | Coin mech | 1 |
| 07 | Meter | 1 |
| 08 | Small button | 1 |
| 09 | Lock 1396# | 1 |
| 10 | Coin box | 1 |
| 11 | Cover | 1 |
| 12 | Plastic pole | 4 |
| 13 | Holder for seat | 1 |
| 14 | Air bag | 4 |
| 15 | Solenoid 4V 210-08 | 4 |
| 16 | Fiberglass for chassis | 1 |
| 17 | Back light blister | 2 |
| 18 | Foundation | 4 |
| 19 | Wheel | 4 |
| 20 | 3-color chasing light strip | 0.4m |

SCHEMATIC DIAGRAM FOR AIR CIRCUIT SYSTEM

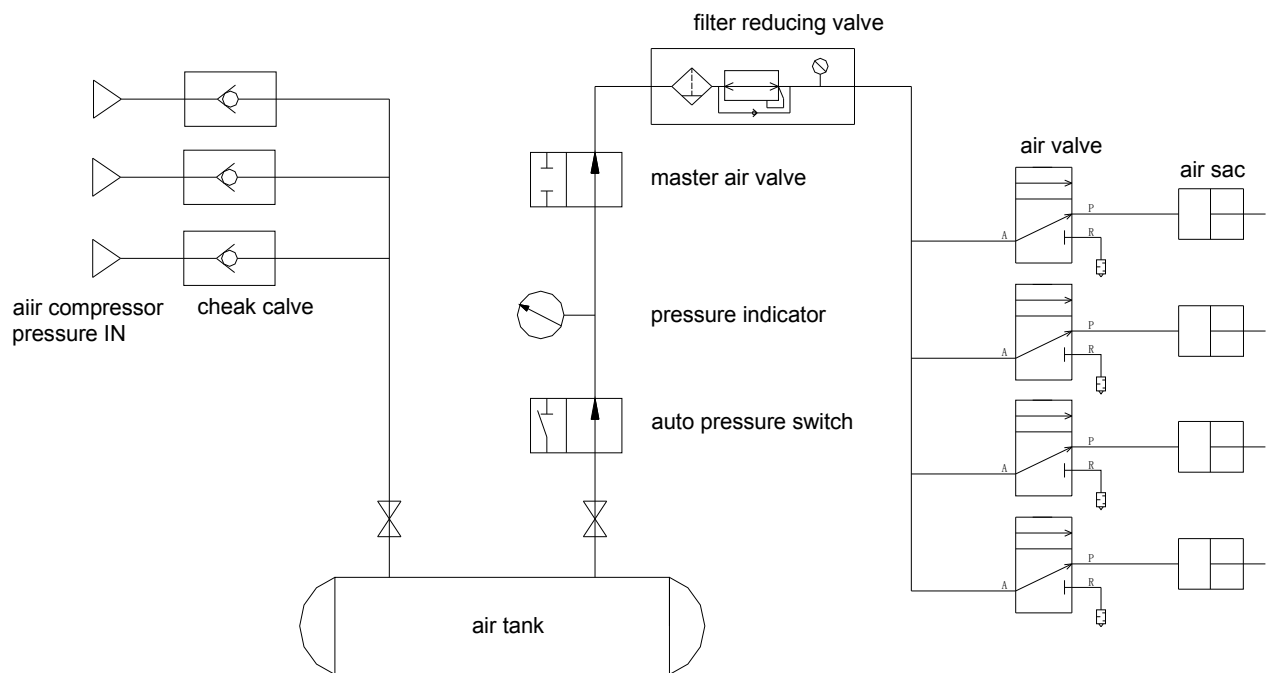

SCHEMATIC DIAGRAM

